



“Limkokwing University has portrayed to me the many facets of the Built Environment especially through the multi-cultural ecosystem within the University”

Edmund Low Lup Yin, Malaysia

Graduated 2008 - BA in Interior Architecture
Now - Interior Architect, Custom Design Group



“Studying in Limkokwing University has broadened my view and Perspectives in Interior Design and the possibilities of the future pathway.”

Felicia Arista Sukuwandono, Indonesia

Graduated 2011 - BA in Interior Architecture
Now - Owner at FULLSTOP, Indonesia



“I’m glad to tell that I have friends from different countries. It is a joy to be able to blend with classmates from different cultures and background. Through that, it opened my mind and thinking, and made me a step further than others in the same Architecture career.”

Cheong Yee Sem, Malaysia

Graduated 2012 - BSc in Architectural Studies
Now - Assistant Architect at UIG Architects, Malaysia

Hi-Income Built Environment Careers

Interior Architecture • Interior Architect • Furniture Designer • Retail Designer • Visualizer • Exhibition Design • Event Manager • Public Space Planner • Commercial Space Planner • Set Designer • Residential Designer • Cad Designer • Information Designer • Project Management Consultant • Color Consultant • Arbitrator For Interior Design **Urban Planning & Design** • Transportation Planner • Consultant Planner • Urban Designer • Urban Planner • Urban Landscape Designer **Landscape Architecture** • Landscape Designer • Landscape Architect • Nursery Manager • Golf Court Designer • Theme Park Designer • Conceptualiser • Project Manager • Landscape Consultant **Construction Management** • Site Manager • Construction Manager • Site Supervisor • Project Manager **Architectural Studies** • 3D Visualiser • Assistant Designer • Design Consultant • Graphic Designer • Architectural Assistant • Project Manager • Project Coordinator • Site Supervisor • Interior Designer/Interior Architect • Landscape Designer • Architectural Model Specialist • Architecture Draftsman • Cad/3D Visualiser • Theme Park Conceptual Architect **Architectural** • Architectural Assistant • Architectural Draftsman • Architectural Photographer



Malaysia’s University of transformation & University of innovation

Double recognition by the Government of Malaysia

Inovasi 1-1, Jalan Teknokrat 1/1, 63000 Cyberjaya, Selangor Darul Ehsan, Malaysia

facebook.com/limkokwing twitter.com/limkokwing youtube.com/limkokwing

Tel: 03 8317 8888 Fax: 03 8317 8988 www.limkokwing.net

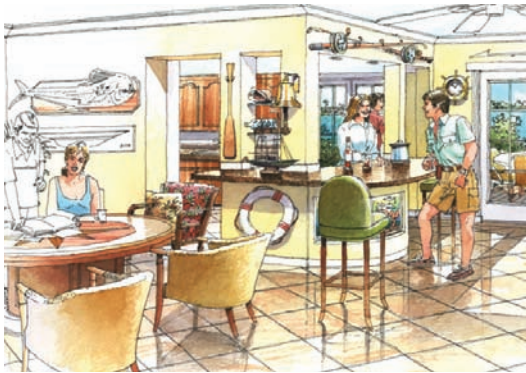

Bachelor of Science (Hons) of Construction Management

is a professional discipline that exists within the overall framework of the construction industry taking into consideration of basic issues such as time frame, availability of material, labor and human resource, and financial constraints.

Entry Requirements

- Pass STPM/A Levels with minimum 2 principals; OR
- Pass Foundation / Matriculation programme in related field; OR
- Pass Diploma in related field
- Any other equivalent qualifications recognised by the Malaysian Government.

Semester 1

- Construction Technology 1
- Building Structure 1
- Site Surveying
- Building Services 1
- Information Technology & Communication
- Technical & Construction Drawings
- Construction Materials 1

Select one:

- Malaysian Studies
- Co-Curriculum 1

Semester 2

- Construction Technology 2
- Building Structure 2
- Building Services 2
- Building Quantities
- Building Estimating
- Building Science
- Construction Materials 2

Select one:

- Bahasa Kebangsaan A/B
- Co-Curriculum 2

Semester 3

- Construction Technology 3
- Construction Management 1
- Construction Law
- Procurement System
- Construction Economics
- Production Management
- CAD-Computer Aided Design

Select one:

- Islamic/Moral Studies
- Co-Curriculum 3

Semester 4

- Construction Management 2
- Sustainable & Green Construction
- Professional Practice & Management

- Contract Management
- Facilities and Maintenance Management
- Research Methodology
- Construction Health & Safety
- Global Classroom

Semester 5

- Construction Industry Attachment

Semester 6

- Construction Management 3
- Project Evaluation & Development
- Financial Management
- Construction Business Management
- Management Theory & Practice
- Research Project

Bachelor of Science (Architectural Studies)

Is the first part of the Architect’s training. The three years delivered in this programme precedes the final two years available in the Bachelor of Architecture. The course provides a mix of architectural and general university studies throughout the program.

Entry Requirements

- Pass STPM/A Levels with minimum 2 principals; OR
- Pass Foundation / Matriculation programme in related field; OR
- Pass Diploma in related field
- Any other equivalent qualifications recognised by the Malaysian Government.

Students with a recognised Diploma in the relevant field will be given credit exemptions based on past results and portfolio review (where applicable).

Semester 1

- Communication Principles for Architecture
- Architectural Design & Theory 1
- Architecture Technology 1
- Architecture Communication 1
- Computer - Aided Design 1
- Architecture Graphics Elective
- Ethnic Relations
- Malaysian Studies

Semester 2

- Architectural Design 2
- Architecture Technology 2
- Architecture Science 1
- Architecture Communication 2
- Architecture History & Theory 1
- Islamic Civilisation and Asian Civilisation
- Communication - Malay Language 2

Semester 3

- Leadership Skills & Human Relations - 2CR
- Entrepreneurship - 2CR
- Architecture Science 2
- Architecture Design 3
- Architecture Technology 3
- Digital Communication
- Architecture History & Theory 2
- Bahasa Kebangsaan A/DIP

Semester 4

- Architecture Design 4
- Architecture Technology 4
- Architecture Science 3
- Architecture Communication 3
- Architecture History & Theory 3
- Global Classroom
- Malaysian Economy
- Government and Public Policy of Malaysia

Semester 5

- Architecture Science 4
- Practical Training 1
- Special Studies
- Architecture Design 5
- Architecture Technology 5
- Architecture History & Theory 4
- Elective 1 - Architecture Conservative Studies

- Community Services
- Co-Curricular

Semester 6

- Architectural Design 6
- Integrated Technologies
- Working Drawing
- Architecture Communications Project
- Architecture Seminar

Bachelor of Civil Engineering

Over the next decade the landscape of the world will be hugely transformed as new and exciting engineering projects materialize, such as the world’s first shipping tunnel, a space age underwater hotel and the world’s biggest shopping mall. At the heart of these projects are civil engineers who plan and build structures as wide training as bridges, buildings, transport systems and dams. The majority of civil engineering careers are with engineering firms or construction companies and the largest percentage of civil engineering careers are as structural engineers.

Entry Requirements

- Pass STPM with 3 principals or ‘A-Levels’ or equivalent or Foundation, Matriculation, or pre-university equivalent and Grade C/grade point 2.0 and above (include Mathematics, Physics and Chemistry);
- or Pass Diploma or Education Malaysia or equivalent and with Grade C/grade point of 2.0 and above (include Mathematics, Physics and Physics)
- or complete Year 12, or equivalent, for international Students endorsed by the embassy of the country of study with Grade C/grade point 2.0 and above (include Mathematics, Physics and Chemistry) and pass the English Placement Test or IELTS with a score of 6.0.

Semester 1

- Engineering Mathematics I (Vector Calculus)
- Statics and Dynamics
- Computer Programming
- Engineering Survey
- Malaysian Studies

Semester 2

- Engineering Mathematics II (Algebra)
- Structural Analysis I
- Strength of Materials
- Bahasa Kebangsaan A/B
- Civil Engineering Materials

Semester 3

- Engineering Mathematics III (Differential Equations)
- Fluid Mechanics
- Environmental Engineering
- CAD in Civil Engineering

- Engineers and Society
- Islamic Studies/Moral Studies

Semester 4

- Engineering Mathematics IV (Statistics)
- Waste water Engineering
- Structural Analysis II
- Soil Mechanics
- Hydrology and Water Resources

Semester 5

- Hydraulics
- Construction Methods and Technologies
- Structural Design I (Reinforced Concrete)
- Foundation Engineering
- Highway & Traffic Engineering

Semester 6

- Sustainable Urban Planning

- Stormwater Management
- Site Investigation
- Professional Ethics and Law
- Structural Design II (Structural Steel) Intersession
- Industrial Training

Semester 7

- Engineering Management
- Capstone Project I
- Structural Design III (Prestressed Concrete)
- Elective I
- Elective II
- Final Year Project I

Semester 8

- Project Management
- Capstone Project II
- Elective III
- Final Year Project II

ARCHITECTURE & BUILT ENVIRONMENT

Architecture and the Built Environment faculty provides the first stage in obtaining professional qualifications in Contrsuction Management, Urban planning & Design Architecture. The courses are dynamic and demanding, bringing a positive contribution to the shaping of the built environment and culture. The programs offers highly respected lifetime careers that involve the society.

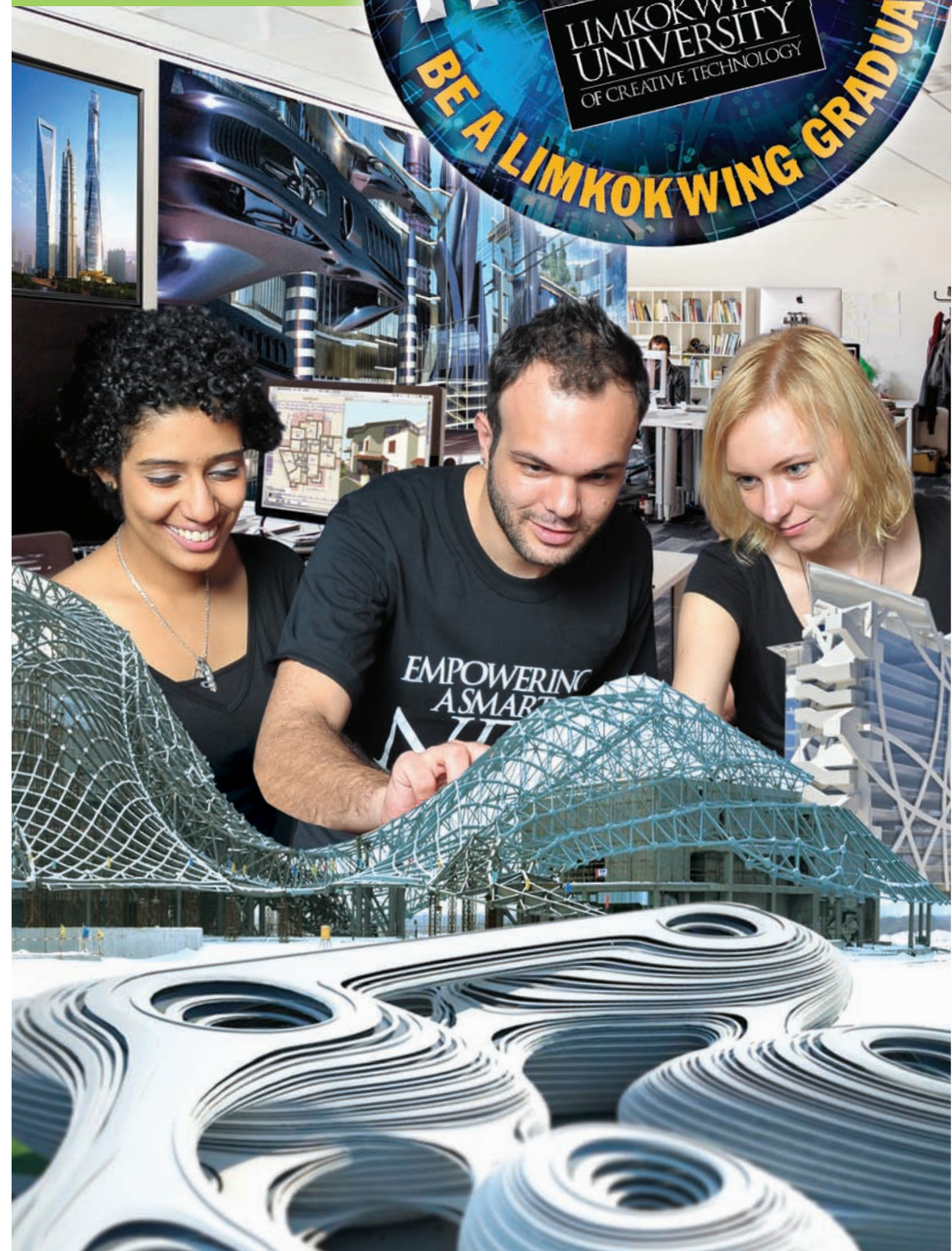



Foundation in Built Environment

The program provides the fundamental and basic knowledge and skills to those who aspire to be involved in the field of Architecture and the built environment. It encompasses all aspects of creative and critical thinking through design development, theory and skill-based modules, while understanding the historical background of the built environment, as well as its applications and other related aspects.

Entry Requirements

- Pass SPM/SPMV/O Level with 5 credits including English language
- Any other equivalent qualifications recognised by the Malaysian Government.

Semester 1	Semester 2	Semester 3
<ul style="list-style-type: none">• Introduction to Design 1• Drawing 1• Foundation Math• Introduction to The Built Environment• Foundation English 151• Malaysian Studies	<ul style="list-style-type: none">• Introduction to Design 2• Drawing 2• Measurements & Applications 152• History & Cultural Studies 1• Foundation English 152• Bahasa Kebangsaan A	<ul style="list-style-type: none">• Introduction to Design 3• Drawing 3• Building Technology & Concepts• History & Cultural Studies 2• Introduction to Project Management• Moral/Islamic Studies*

Diploma

Diploma in Civil Engineering

Civil Engineering, the most diverse branch of engineering, is directly related to facilities and systems used by the public in their daily life. Civil engineers are engaged in the planning, design, construction, and maintenance of bridges, buildings, foundations, dams, sanitary and solid waste disposal systems and related environmental considerations, highways, airport facilities, transportation systems, waterways, hydroelectric installations, pipelines, coal preparation and loading facilities, and other systems and structures. Engineering students get a sound basic knowledge of science and a set of core courses in humanities and social sciences.

Entry Requirements

- Sijil Pelajaran Malaysia (SPM) or equivalent with at least 3 credits including Mathematics and one science, technical or vocational subject AND pass English,OR
- Pass Certificate level in related field by a certified Higher Education Provider (HEP) with CGPA at least 2.00, OR
- Pass Certificate of Vocational /Technical /Skills * in related field by certified Higher Education Provider (HEP) or equivalent with 1 year work experiences in related field or minimum 1 semester bridging programme and pass SPM with a least 1 credit; or #Only Skills Certificate (SKM) Level 3 is accepted.

Semester 1	Semester 2	Semester 3
<ul style="list-style-type: none">• Mathematics-1• Engineering Physics-I & LAB• Engineering Chemistry & LAB• Computer Application LAB• Introduction to Built Environment• Malaysian Studies (Degree)	<ul style="list-style-type: none">• Bahasa Kebangsaan B DIP/DEG(International)• Engineering Calculation• Mathematics-1I• Engineering Physics-II & LAB• Engineering Drawing• Construction Materials• Bahasa Kebangsaan A DIP/DEG(Local)	<ul style="list-style-type: none">• Surveying 2 & LAB• Structural Engineering Design 2 (Steel)• Quantity Surveying• Concrete Technology and Construction• Water and Wastewater Management• CAD in Civil Engineering LAB 2• Construction LAB• Construction Management• Building Interior Design• Urban Planning• Final Project

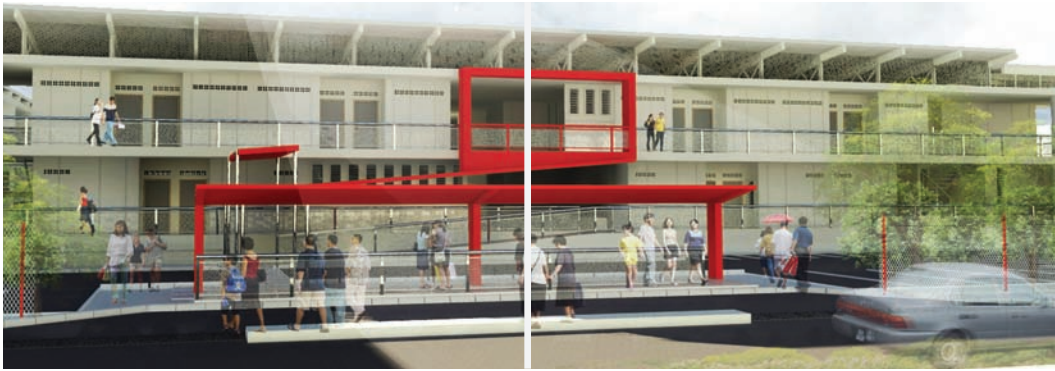

Diploma in Architectural Technology

The program is designed to prepare students for a career that supports the building design industry. It equips students with the necessary technological skills and knowledge that range from building services, building construction, building technology and materials, technical and CAD drawings and office practice.

Entry Requirements

- Pass SPM/O Level with 3 credits including English language
- Any other equivalent qualifications recognised by the Malaysian Government.

Semester 1	Semester 2	Semester 3
<ul style="list-style-type: none">• Building Construction 1• Building Structure 1• Architecture Drawing 1• Architecture Design 1• Foundation English 151• Communication - Malay Language 1 (International)• Malaysian Studies (local)	<ul style="list-style-type: none">• Building Construction 2• Building Materials 2• Building Structure 2• Architecture Drawing 2• Architecture Design 2	<ul style="list-style-type: none">• Foundation English 152• Thinking Skills (local)• Bahasa Kebangsaan A (International)• Building Construction 3• Architecture Drawing 3• Architecture Computing• Architecture Design 3• Building Services 1• Constitution and Society of Malaysia• Building Construction 4• Working Drawing

Diploma in Interior Design

This program exists in the overall framework of the building industry with its own area of specialty and considerations primarily for the interior environment. The course takes into consideration basic human needs and aspirations for living through its expressions of style, structure, function and form.

Entry Requirements

- Pass SPM/O Level with 3 credits including English language
- Any other equivalent qualifications recognised by the Malaysian Government.

Semester 1	Semester 2	Semester 3
<ul style="list-style-type: none">• Introduction to Design 1• Drawing 1• Creative Studies• Measurement & Application 152• History & Culture 1• General English• Communication - Malay Language (International)/ Malaysian Studies (Local)	<ul style="list-style-type: none">• Design 2• Drawing 2• Building Materials 152• History & Culture 2• Intro to Building Science	<ul style="list-style-type: none">• & Construction• Communication Studies 1• Thinking Skills / Bahasa Kebangsaan A*• Design 3• Drawing 3• CADD 1• Building Construction• History & Culture 3• Foundation English 151• Constitution & Society of Malaysia• Design 4• Drawing 4• CADD2

Degree

Bachelor of Arts in Interior Architecture

Enables students to solve realistic problems related to interior spaces and build up sound knowledge of construction as well as technical issues. This will see students develop understanding of the relationship between architecture, interiors and project management.



Entry Requirements

- Pass STPM/A Levels with minimum 2 principles; OR
- Pass Foundation / Matriculation programme in related field; OR
- Pass Diploma in related field
- Any other equivalent qualifications recognised by the Malaysian Government.

Students with a recognised Diploma in the relevant field will be given credit exemptions based on past results and portfolio review (where applicable).

Semester 1	Semester 2	Semester 3
<ul style="list-style-type: none">• Interior Architecture 141• Architectural Graphic 141• Building Construction & Materials 141• Architecture Culture & History 141• Theory & Practice of Design 141• Building Science 141• Environmental Psychology• Ethnic Relations / Malaysian Studies 3	<ul style="list-style-type: none">• Seminar / Workshop• Interior Architecture 142• Digital Communication 142• Design Commucation 142• Building Construction & Materials 142• Architecture Culture & History 142• Building Science 142• Islamic Civilisation and Asian Civilisation / Communication	<ul style="list-style-type: none">• Malay Language 2• Furniture Design Workshop 241• Interior Architecture 241• Digital Communication 241• Design Communication 241• Building Technology 241• Architecture Culture & History 241• Building Science 241• Bahasa Kebangsaan A DIP/DEG (Local)• Leadership Skill & Human Relations / Entrepreneurship• Furniture Design Workshop 242• Furniture Furnishing Fitting & Equipment 242• Interior Architecture 242• Digital Communication 242• Design Communication 242• Building Technology 242

Bachelor of Arts in Urban Planning & Design

Is a professional discipline that explores several aspects of the built and social environment cities and communities anticipating the future outlook of the city. The design aspects responds to changes of the technology as well as construction that deals with the look and aesthetic details of urban places and spaces.

Entry Requirements

- Pass STPM/A Levels with minimum 2 principles; OR
- Pass Foundation / Matriculation programme in related field; OR
- Pass Diploma in related field
- Any other equivalent qualifications recognised by the Malaysian Government.

Students with a recognised Diploma in the relevant field will be given credit exemptions based on past results and portfolio review (where applicable).

Semester 1	Semester 2	Semester 3
<ul style="list-style-type: none">• STUDIO 1 (Basic Planning & Design Skills-Manual)• Introduction to Planning• Evolution of Planning Ideas• Communication Principles 111• Computer Aided Design 1• Ethnic Relations (Local students)• Malaysian Studies (International students)	<ul style="list-style-type: none">• Design Skills-CAD)• Site Planning• Malaysian Society• Computer Aided Design 2• Elective 1 – Plant Material• Elective 1 – Project Management• Islamic Civilization and Asian Civilization (local students)• Communication Malay Language 3 (international students)	<ul style="list-style-type: none">• STUDIO 3 (Layout Design1) Planning Studio 3• Land Use Planning 1• Development & Urban Environment• G.I.S in Planning• Bahasa Kebangsaan A (local student)• Leadership Skill & Human Relations (Local/International)• Entrepreneurship (Local/International)

Semester 4

- STUDIO 4 (Layout Design2)
- Land Use Planning 2
- Transport and Traffic Planning
- Urban Economy Geography
- Infrastructure Planning
- Malaysia Economy (Local/ International)
- Government and Public Policy of Malaysia (Local/ International)
- Community Services (Local/ International)
- Work Sociology and Malaysia Industry

- Shaping The Metropolis
- Community & Housing Diversity
- Public Policy Making – Structure Plan
- Planning Law (Malaysian Context)
- Global Classroom

- Computer
- Research Methodology
- Public Policy Making 2 – Local Plan
- Government and Politics in Planning
- STUDIO 6 (Urban Design & Conservation)

Semester 6

- Industrial Training

Semester 7

- STUDIO 6 (Urban Design & Conservation)
- Planning Theory
- Environmental and Sustainable Studies
- Quantitative Technique and

Semester 8

- Planning Practice
- Research Project
- Development Control & Management
- Elective 2 - Architecture Conservation
- Elective 2- Construction Economics

Bachelor of Arts in Landscape Architecture

Bachelor of Arts in Landscape Architecture is the profession which applies art and science principles to the research, planning, design and management of both natural and built environments. Landscape Architecture is a multi-disciplinary field, incorporating aspects of botany, horticulture, the fine arts, architecture, industrial design, geology and the earth sciences, environmental psychology, geography, and ecology that concerning the design and use of outdoor spaces and the land that includes site planning, town or urban planning, park and recreation planning, regional planning, garden design and historic preservation.

Entry Requirements

- Pass STPM/A Levels with minimum 2 principals; OR
- Pass Foundation / Matriculation programme in related field; OR
- Pass Diploma in related field
- Any other equivalent qualifications recognised by the Malaysian Government.

Semester 1	Semester 2	Semester 3
<ul style="list-style-type: none">• Basic Design Studio 1• Basic Landscape Design Theory• Landscape Graphic 1• English for communication• Ethnic Relations (local)• Malaysian Studies (International students)	<ul style="list-style-type: none">• Landscape Design Studio 2• Landscape Design Theory• Plant Material• Landscape Graphic 2• Islamic Civilization and Asian Civilization• Communication Malaysia Language 3• Moral Studies• Co-Curriculum 2	<ul style="list-style-type: none">• STUDIO 3 (Layout Design1) Planning Studio 3• Land Use Planning 1• Development & Urban Environment• G.I.S in Planning• Bahasa Kebangsaan A (local student)• Leadership Skill & Human Relations (Local/International)• Entrepreneurship (Local/International)

- Material and Technology in Landscape
- History & Philosophy in Landscape
- Computer Aided Design 1 Select One:
- Bahasa Kebangsaan A (local)
- Leadership Skill & Human Relations
- Entrepreneurship

- Landscape Design and Planning Studio 1
- Asia Landscape
- Landscape Construction & Technology
- Environmental and Sustainable Design
- BLA Elective 1

Semester 4

- Landscape Design Studio 2
- Soil Science
- Introduction to Landscape Construction
- Computer Aided Design CAD Select One:
- Malaysia Economy
- Government and Public Policy of Malaysia
- Community Services
- Work Sociology and Malaysian Industry

Semester 6

- Landscape Design and Planning Studio 2
- Malaysia Landscape
- Landscape Maintenance
- Research methodology
- BLA Elective 2

Semester 7

- Office Practice

Semester 8

- Landscape Final Design Studio
- Project Management
- Housing Law
- Landscape Research Project